

※別売りの「NB-019 ナノブロック専用ピンセット」や「NB-020 ナノブロックパッド」を使うと組み立て、取りはずしに便利です。
Use "NB-019 nanoblock Tweezers" and "NB-020 nanoblock Pad" (each sold separately) for an easy way to assemble and disassemble blocks.

White	x1	x1	x4	x2	x4	x2	x10	x6	x22	x4	x5	x4	x2	x1
White	x2	x2	x4	x2	x4	x3	x4	x8	x6	x7	クリアブルー Clear Blue	x3	x2	ライトグレー Light Gray
White	x1	x6	x2	x2	x2	x4	x8	x1	x6	x8	クリア Clear	x3	x1	
White	x1	x10	x4	x3	x5	x2	x2	x2	x5	x2	クロムイエロー Chrome Yellow	x7	x1	
White	x1	x8	x3	x4	x3	x7	x1	x14	x2	x2		x4	x1	
White	x5	x6	x1	x6	x2	x9	x12		x2	x2		x4	x7	
White														

※角度の違う2種類の部品に注意してください。
Note that there are two types of blocks, each with different angles.

1. Assemble the base structure with white and red blocks.

2. Add red blocks to the top of the base.

3. Complete the top layer of the base.

4. Add red blocks to the sides of the base.

5. Add red blocks to the top of the sides.

6. Add red blocks to the top of the sides.

7. Add red blocks to the top of the sides.

8. Add red blocks to the top of the sides.

9. Add red blocks to the top of the sides.

10. Add yellow blocks to the top of the sides.

11. Add red blocks to the top of the sides.

12. Add red blocks to the top of the sides.

13. Add red blocks to the top of the sides.

14. Add red blocks to the top of the sides.

15. Add red blocks to the top of the sides.

16. Add red blocks to the top of the sides.

17. Add red blocks to the top of the sides.

18. Add yellow blocks to the top of the sides.

19. Add yellow blocks to the top of the sides.

20. Add yellow blocks to the top of the sides.

21

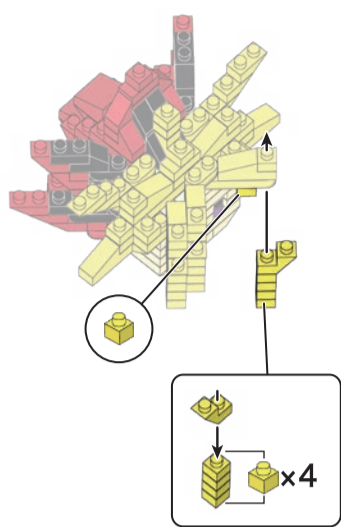

22

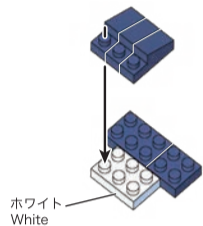

23

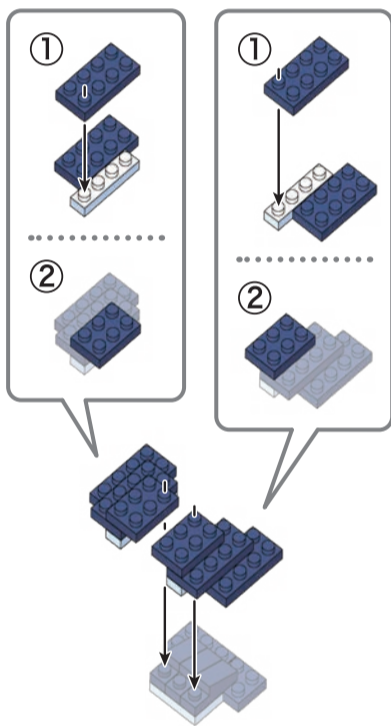

24

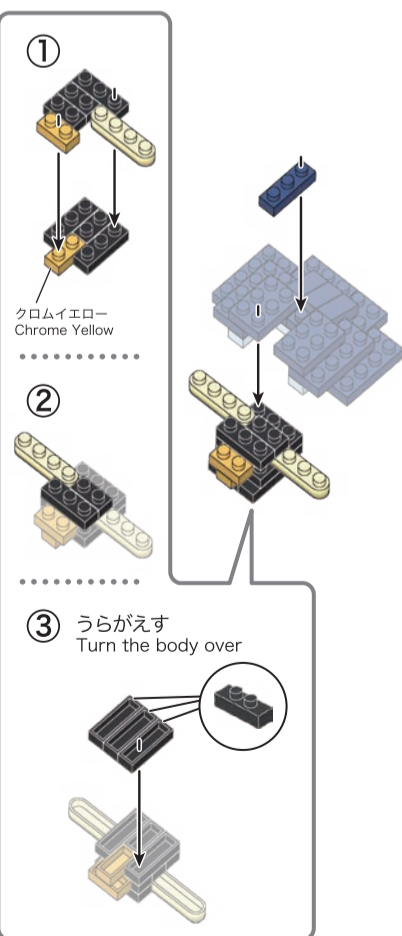

25

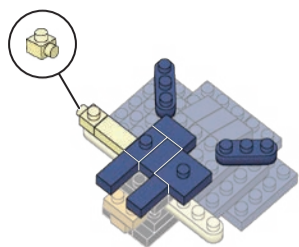

26

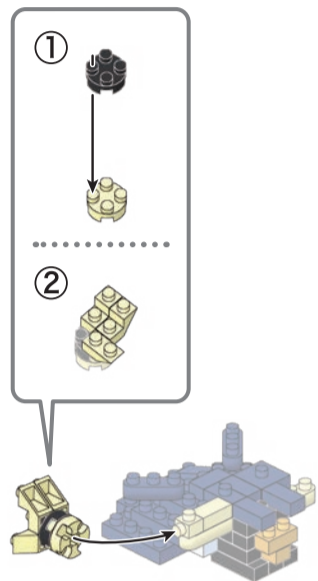

27

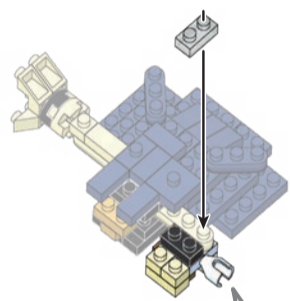

28

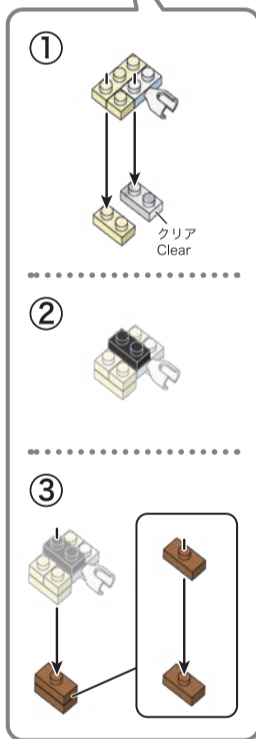

28 うらがえす
Turn the body over

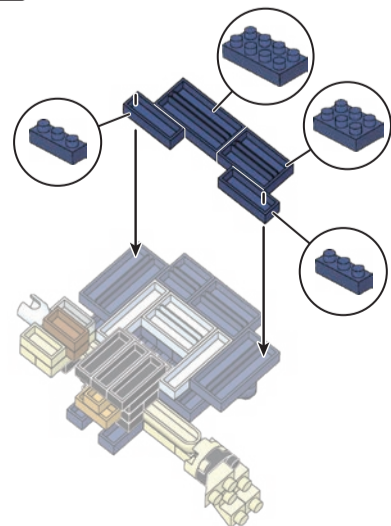

29

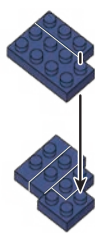

30

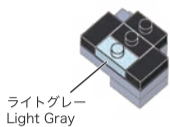

31

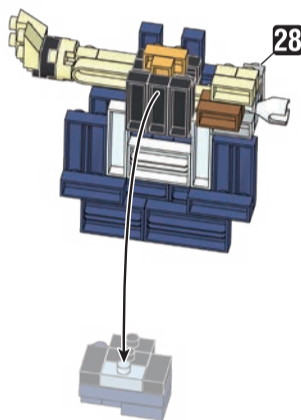

32

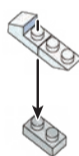

33

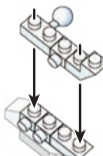

34

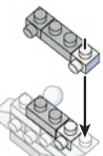

35

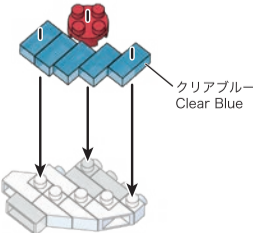

36

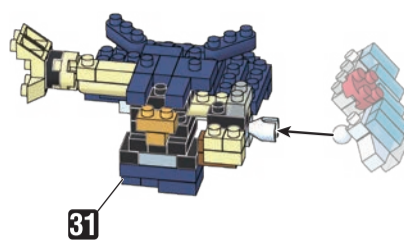

37

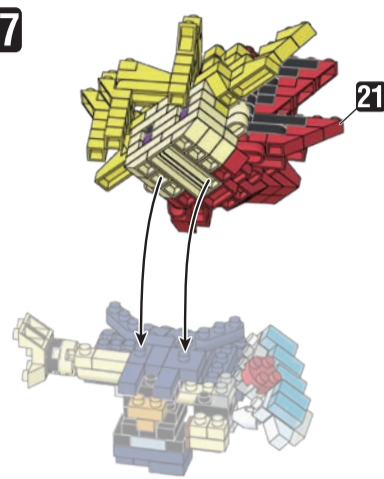

38

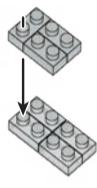

39

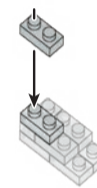

40

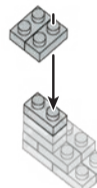

41

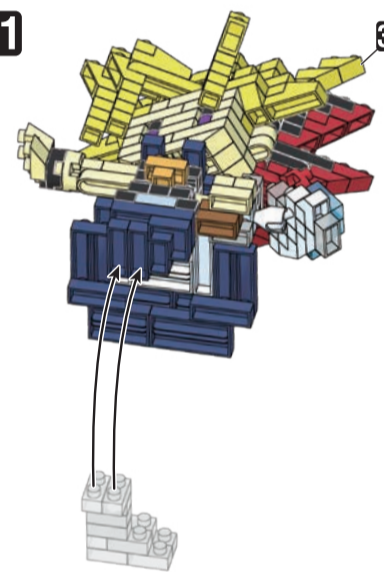

42

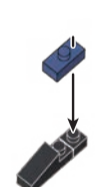

44



43

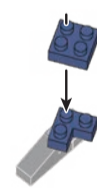

45



46

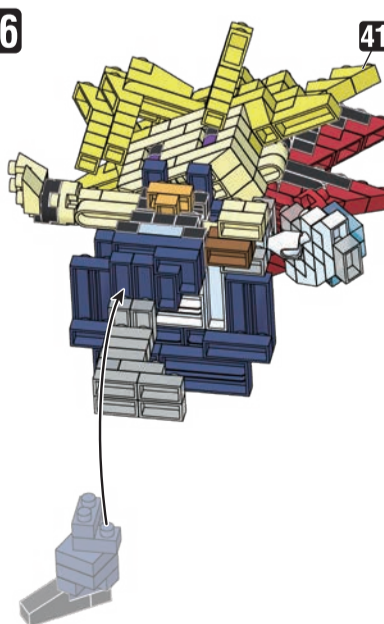

47



48



49

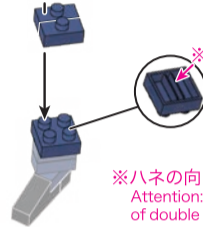

※ハネの向きに注意
Attention: Direction
of double ridges

50

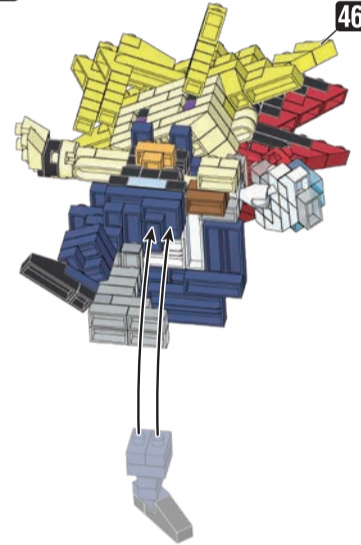

51

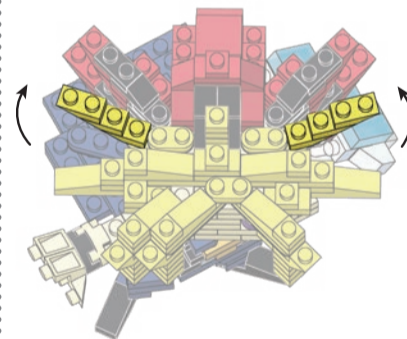

完成!
Finished!

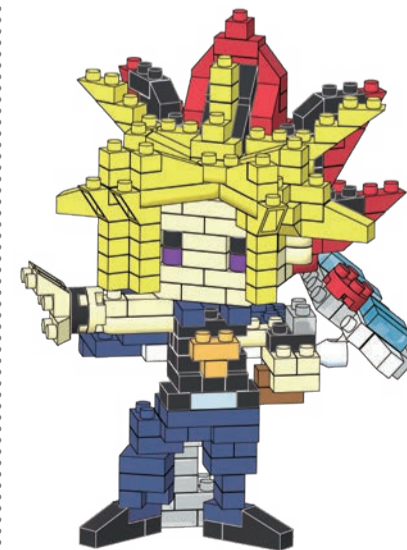

※部品は多めに入っております
Extra blocks included